

2

Bottom View

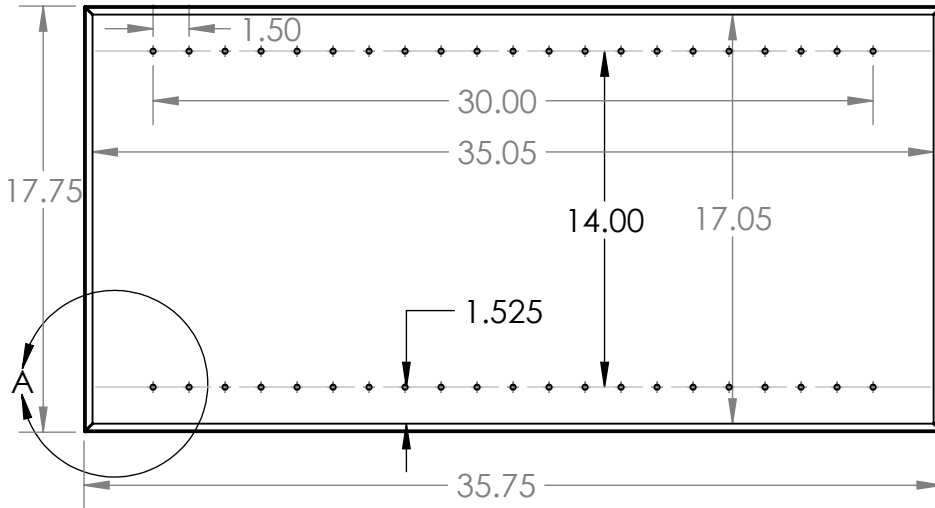

B

1

Bottom Isometric View

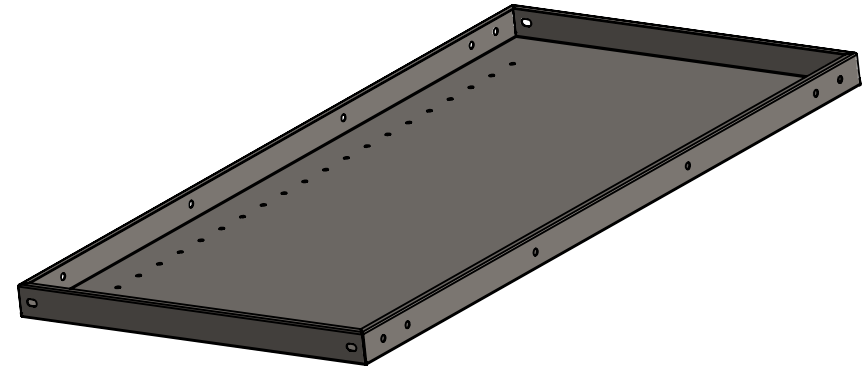

B

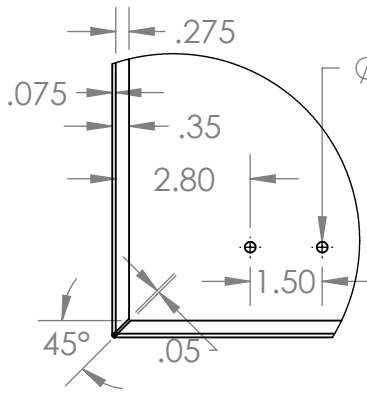

DETAIL A
SCALE 1 : 4

Side View 1

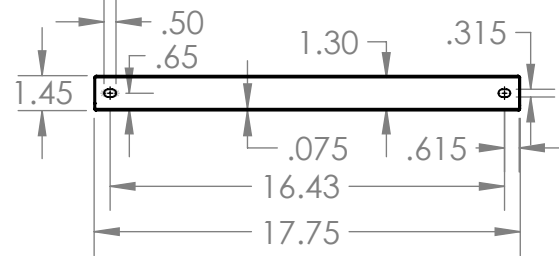

Side View 2



A

PROPRIETARY AND CONFIDENTIAL

THE INFORMATION CONTAINED IN DRAWING IS THE SOLE PROPERTY OF DIXIE SHELVING CONCEPTS. ANY REPRODUCTION IN PART OR AS A WHOLE WITHOUT THE WRITTEN PERMISSION OF DIXIE SHELVING CONCEPTS IS PROHIBITED.

UNLESS OTHERWISE SPECIFIED:

DIMENSIONS ARE IN INCHES
TOLERANCES: ± 1/32"

MATERIAL: 20 GAUGE STEEL - THIS SIZE SHELF IS ALSO AVAILABLE IN 18 GAUGE STEEL

FINISH: POWDER COATED

PART FOR ASSEMBLY OF:
INDUSTRIAL METAL SHELVING STORAGE SYSTEM
WITH A LENGTH OF 36" AND A WIDTH OF 18"

SIZE	DWG. NO.
A	1

DO NOT SCALE DRAWING

DRAWN BY: NICK LOUPE (7/11/2018)

TITLE:

Industrial Metal Shelving: Shelf - L x W = 36" x 18"

COMMENTS: SHELVES AVAILABLE IN 5 SKEWS (CLASS: "O", "T", "IA", "II", & "III") WITH VARIANT SUPPORT ATTRIBUTES AND STEEL THICKNESSES
- SHELF CLASSES ARE DEPENDENT ON USER DEFINED LOAD NECESSITIES
- CONSULT INDUSTRIAL METAL SHELVING PAMPHLET FOR MORE DETAILS ON LOAD CAPABILITIES AND SHELF CLASS DIFFERENCES

SCALE: 1:8 WEIGHT: 8.3 LBS. SHEET 1 OF 1



2

1

A